

Johannesburg
Homemakers
EXPO

22 - 25 February 2007
Main Arena

- KEY**
- Toilet Facilities
 - Disabled Facilities
 - Loading Bays
 - Fire exits
 - Fire Hydrant
 - Telephones
 - Catering Facilities
 - Medical Clinic
 - Parking Bays
 - Tiled Areas
 - ATM - Cash facility
 - Event Office
 - Tenant Office
 - Storerooms

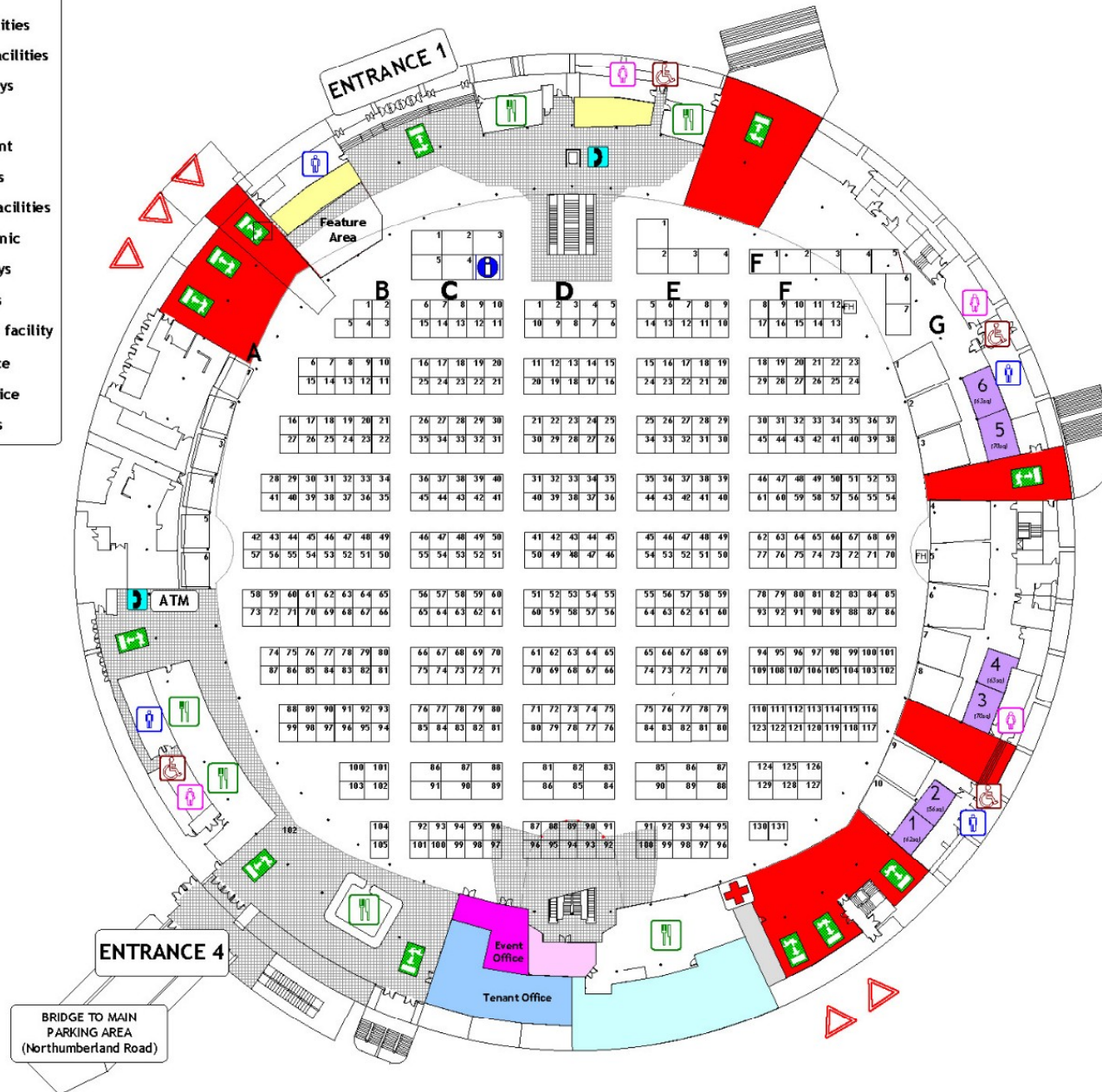

Stand Sizes

- 12sqm (4x3) : B100 - B103; F5; F124 - F129
 - 15sqm (5x3) : C86 - C91; D81 - D86; E85 - E90
 - 19sqm (5,3 x 4 x 4,3 x 4) : F5
 - 20sqm (5x4) : C1 - C5; E2 - E4; F1 - F4; F6; F7
 - 22sqm (5,5 x 4) : A1 - A6
 - 25sqm (5x5) : E1
 - 48sqm (9,5 x 10) : G1 - 3; G7 - G10
 - 67sqm (11,5 x 10,5) : G4; G5; G6
 - 133sqm : Entrance 1 Feature
- All other stands are 9sqm stands

Floor Loading - Weight Distribution

- SIDE "A"**
2.5 Tons / sqm with a 10 Ton(UDL)
- SIDE "B"**
0.5 Tons / sqm with a 3 Ton(UDL)
- SCALE**
1mm = 1m

